

Brio®

W  
E  
B  
S  
I  
T  
E

Tankless RO Filtration System  
with Brushed Nickel Faucet

Setup Manual



TROM400STD



TROM600STD



TROM800STD

# Table of Contents

<b>Safety Information</b> .....	<b>3</b>
<b>Package Contents</b> .....	<b>4</b>
<b>Product Features</b> .....	<b>5</b>
Interface Features .....	5
Operational Specifications .....	6
Technical Specifications .....	6
<b>Installation</b> .....	<b>6</b>
Installation Overview .....	6
How to Use Quick-Connect Fittings .....	7
Convert to a 1/2" Connection .....	7
Connect to the Cold Water Supply .....	8
Install the Faucet .....	9
Connect the RO Wastewater Tube .....	10
Connect Tubes to Filtration Unit .....	11
Check for Leaks .....	11
Flush the Filter .....	11
<b>Operation</b> .....	<b>12</b>
Indicator Lights and Buttons .....	12
<b>Care and Maintenance</b> .....	<b>12</b>
Filter Replacement Schedule .....	12
Replace the Filters .....	13
<b>Troubleshooting</b> .....	<b>14</b>
Modes .....	14
<b>Warranty</b> .....	<b>15</b>

# Safety Information

**WARNING:** To reduce risk of injury and property damage, you must read this entire guide before assembling, installing, and operating this filtration system.

- This RO water filtration system is not intended for use by persons (including children) with reduced physical, sensory, or mental capabilities, or lack of experience and knowledge, unless they have been given supervision or instruction concerning use of the appliance by a person responsible for their safety.
- This RO water filtration system requires a dedicated 3-prong outlet. If you do not have one, consult a professional electrician to have one installed.
- DO NOT use system if power cord is damaged. Contact customer service immediately for a replacement. When unplugging power cord ALWAYS grasp plug firmly to remove. DO NOT pull on power cord itself as this may cause damage or electrical shock.
- DO NOT remove ground prong.
- DO NOT use with extension cord.
- DO NOT use with adapter.
- ALWAYS insert power plug fully and securely. Failure to do so may cause fire due to electric leakage or heat generation.
- Wipe off accumulated dust or dirt on power plug. Accumulated dust or dirt may cause fire, electric shock, or a short circuit.
- DO NOT disassemble, remodel, modify, or repair the filtration system. This may result in fire, electric shock, or fault, and cause serious injuries. If a repair is required, contact vendor for assistance.
- For indoor use ONLY. DO NOT expose water purifier to direct sunlight. ALWAYS install water filtration unit on a level, sturdy surface.
- DO NOT store or expose system to temperatures lower than 32°F (0°C).
- DO NOT install filtration system near heat sources, open flames, or combustible substances.
- DO NOT place magnetic devices near system as damage could occur.
- DO NOT place objects on top of filtration unit as this may cause fire or electric shock.
- DO NOT allow children near system without adult supervision.
- DO NOT use this water filtration system with microbiologically unsafe water or water from unknown sources or quality.
- DO NOT use abrasive or harsh cleaners, or cleansers containing petroleum products. DO NOT use paper towels, scouring pads, or other harsh cleaning tools. These can scratch or damage unit.
- DO NOT reset filters prematurely. Filters must be replaced to avoid germ contamination inside water filtration system.
- Water filtration system should be used regularly. If not used for 3 days or more, flush system for 5 minutes.
- If the water filtration system is not to be used for a long period of time, close inlet water valve, press power button OFF, and unplug power cord.
- It is normal that a slight noise and vibration occur when water filtration system is producing water.

# Package Contents

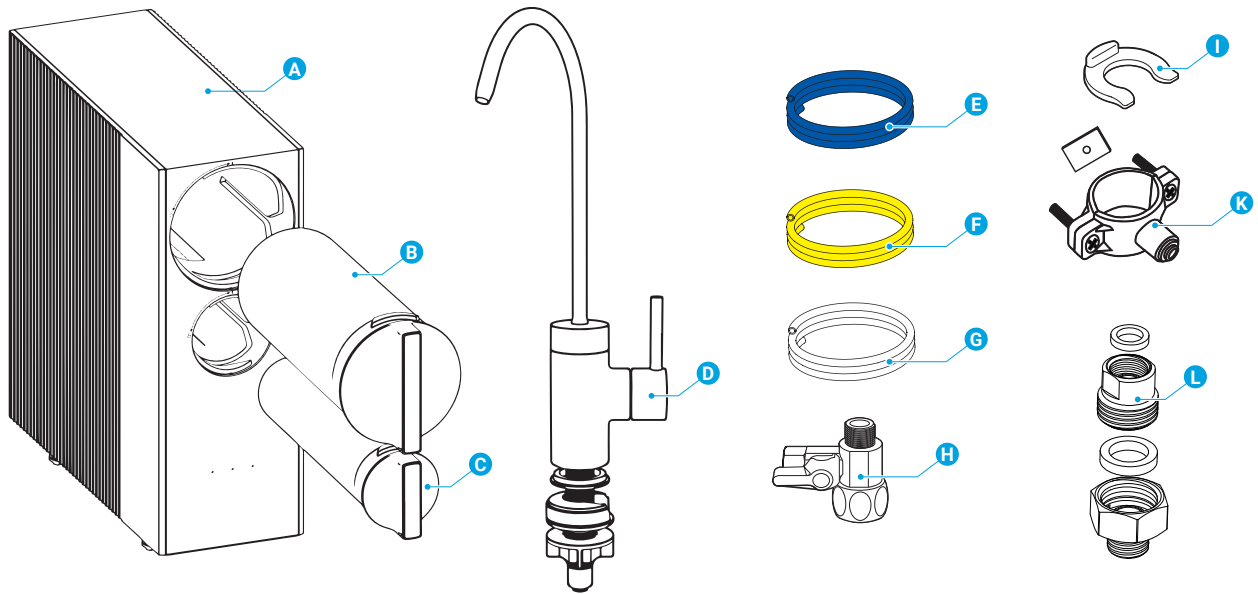

Part	Description
A	Filtration unit
B	RO filter
C	PAC filter
D	Filtration faucet and parts
E	Blue inlet-water PE tube
F	Yellow purified-water PE tube

Part	Description
G	Long white drain-water PE tube
H	Feedwater valve
I	Locking clip (x8)
K	Drain saddle
L	Feedwater valve adapter

# Product Features

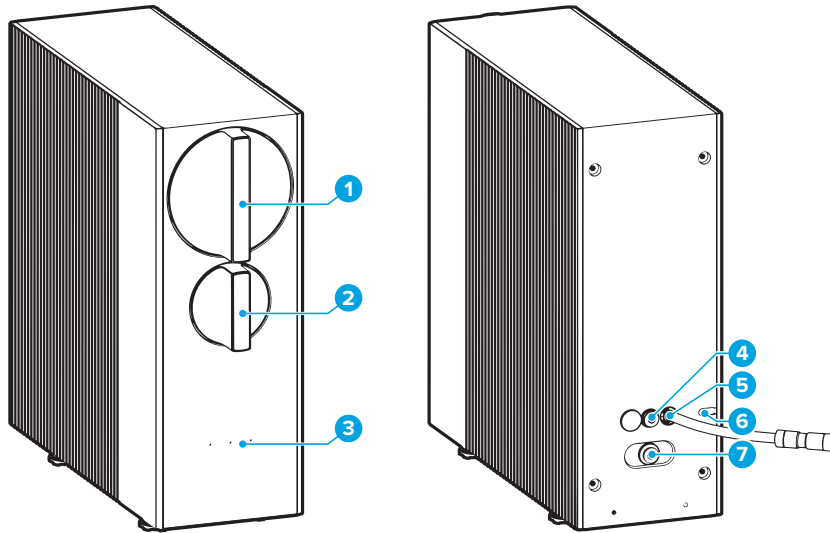

Part	Description
1	RO filter compartment
2	PAC filter compartment
3	Indicator panel
4	Purified water outlet

Part	Description
5	RO drain with preinstalled tube and flow restrictor
6	Power cord
7	Raw water inlet

## Interface Features

No.	Description
8	PAC filter indicator
9	RO filter indicator
10	Power indicator
11	RO filter reset button
12	PAC filter reset button
13	Power button

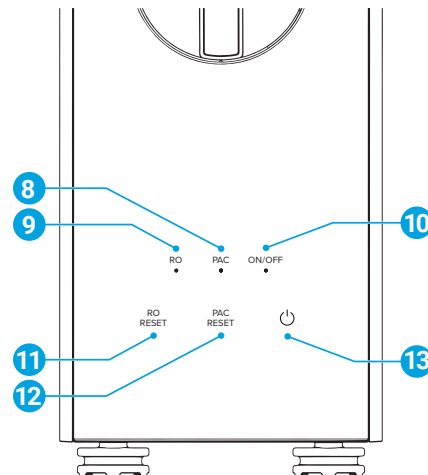

## Operational Specifications

Model No.	TROM400STD	TROM600STD	TROM800STD
Rated Voltage / Frequency	110–120 V~50/60 Hz	110–120 V~50/60 Hz	110–120 V~50/60 Hz
Rated Current	4A	4A	4A
Power Consumption	60 W	85 W	85 W
Feedwater Water Pressure	14 – 100 psi / 0.1 – 0.69 MPa	14 – 100 psi / 0.1 – 0.69 MPa	14 – 100 psi / 0.1 – 0.69 MPa
Feedwater Requirement*	Municipal Water with TDS <750 ppm	Municipal Water with TDS <750 ppm	Municipal Water with TDS <750 ppm
Turbidity	Up to 1 NTU	Up to 1 NTU	Up to 1 NTU
Feedwater Temperature	40 – 100 °F (4 – 38 °C)	40 – 100 °F (4 – 38 °C)	40 – 100 °F (4 – 38 °C)
Operating Ambient Temperature	40 – 100 °F (4 – 38 °C)	40 – 100 °F (4 – 38 °C)	40 – 100 °F (4 – 38 °C)
Operating Ambient Humidity	≤90%	≤90%	≤90%

\*If using well or ground water as feedwater source, ensure it has been through prefiltration before using with water filtration system.

## Technical Specifications

Model No.	TROM400STD	TROM600STD	TROM800STD
Daily Purified (RO) Production Rate	400 GPD	600 GPD	800 GPD
Purified Water Flow Rate	1.0 L/min	1.5 L/min	2.0 L/min
Purification Capacity	60 L/h	90 L/h	120 L/h
Recovery Rate (Pure to Waste)	1:1	1.5:1	2:1
Product Dimensions (WxHxD)	5.2 x 13.7 x 14.0 in. (13.2 x 34.8 x 35.56 cm)	5.2 x 13.7 x 14.0 in. (13.2 x 34.8 x 35.56 cm)	5.2 x 13.7 x 14.0 in. (13.2 x 34.8 x 35.56 cm)
Net Weight	17.19 lb (7.8 kg)	17.19 lb (7.8 kg)	17.19 lb (7.8 kg)
Noise	≤45 dBA	≤45 dBA	≤45 dBA

## Installation

This water filtration system should be installed under the sink in an easy-to-access location with at least 4 in. (10 cm) of free space around the unit to allow for proper ventilation.

Ensure there is a dedicated GFCI outlet nearby. This outlet **MUST NOT** be an outlet shared with any other appliance, for instance, a garbage disposal.

Ensure the power supply cord and PE tubing can be routed without kinking or bending.

### Installation Overview

#### Materials Needed

- Variable speed drill
- 2 Drill bits: 1/4" for drainpipe, 1" for faucet hole (if there is no preexisting hole)
- Adjustable wrench
- Phillips-head screwdriver
- Safety glasses
- Plumber's tape
- Bucket

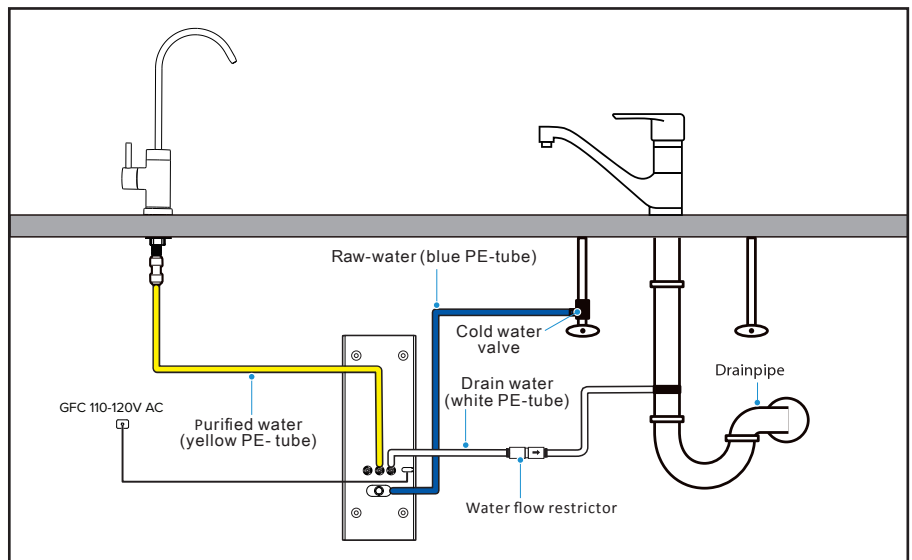

## How to Use Quick-Connect Fittings

The inlet, outlets, and connections of this water filtration system use quick-connect fittings to ensure an easy installation.

To connect a PE tube to the fitting, follow these steps:

- A.** Insert the PE tube into the quick-connect fitting. There is a mark on the PE tube to ensure you fully insert the tube into the fitting.
- B.** To secure tube, slide a locking clip between the quick-connect release collar and the fitting. (Fig. 1)

To disconnect a PE tube from a fitting, follow these steps:

- A.** Slide the locking clip out from the quick-connect release collar.
- B.** Press down and hold the quick-connect release collar. This will release the PE tube. Then pull the PE tube out of the fitting. (Fig. 2)

(Fig. 1)

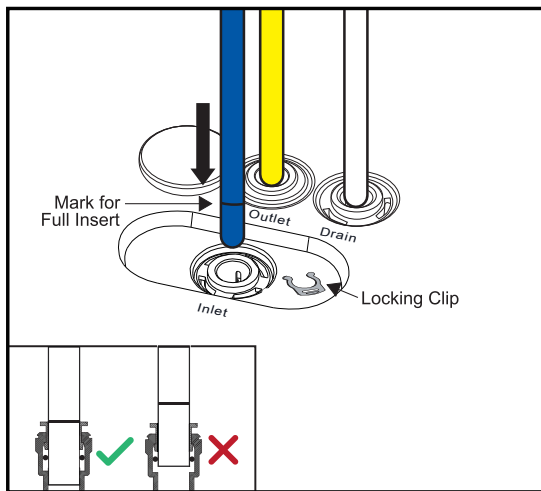

(Fig. 2)

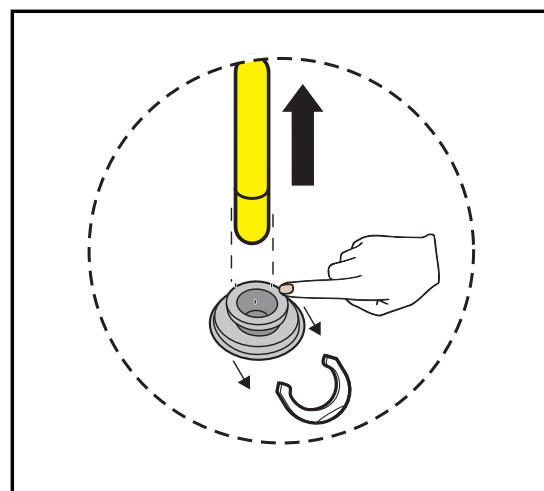

## Convert to a 1/2" Connection

The supplied feedwater valve is designed for a 9/16" NPT cold water pipe. However, an adapter has been included if you have 1/2" connections. Follow these steps to make the conversion:

- A.** Attach nut B to the top of the feedwater valve. Tighten by hand or adjustable wrench.
- B.** Attach nut A to the bottom of the feedwater valve. Tighten by hand or adjustable wrench.
- C.** You can now proceed to "Connect to the Cold Water Supply."

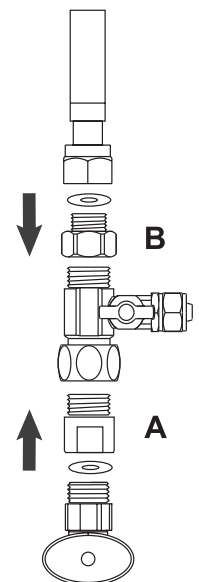

## Connect to the Cold Water Supply

**CAUTION:** DO NOT CONNECT THIS WATER LINE TO A HOT WATER SUPPLY LINE. The water supply to the unit MUST be from the COLD WATER LINE. Using HOT WATER will severely damage your filters.

**NOTE:** We recommend using plumber's tape on any additional threaded connections you may need to make during installation. Do not use plumber's tape on the included feedwater adapter, as it has a built-in gasket that creates a proper seal without tape.

**NOTE:** The following illustrations show installation for 3/8" cold water connections. If you have 1/2" cold water connections, see "Convert to a 1/2" Connection" before proceeding with installation.

- A. Turn off cold water supply. Open faucet and drain any remaining water in pipes.
- B. Using an adjustable wrench, disconnect cold water pipe from cold water supply line.
- C. Twist feedwater valve onto the cold water supply valve (with its washer) and tighten with adjustable wrench.
- D. Twist the cold water pipe (with its washer) onto the top of the feedwater valve and tighten with an adjustable wrench.
- E. Connect one end of blue inlet-water PE tubing to feedwater valve, then tighten the nut.

**NOTE:** To facilitate insertion of tubing, immerse the end of the PE tube to be connected in warm water for a few minutes, then connect it to the feedwater valve.

**NOTE:** Do not connect the other end of the blue inlet-water PE tube to the filtration unit at this time.

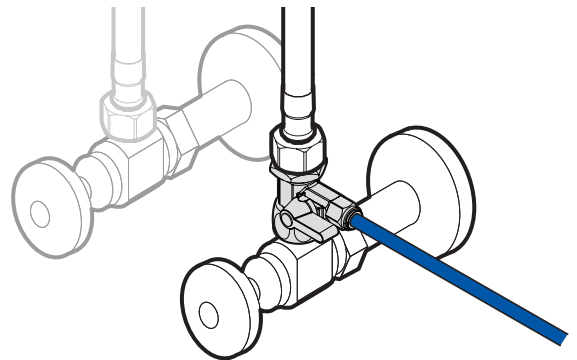
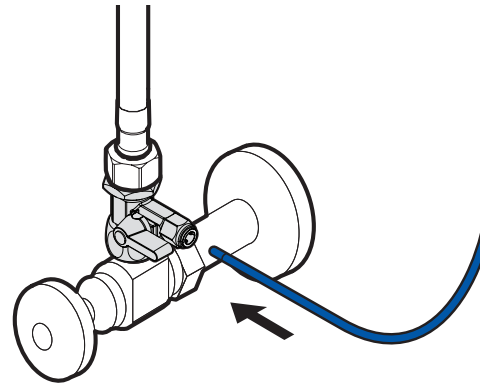
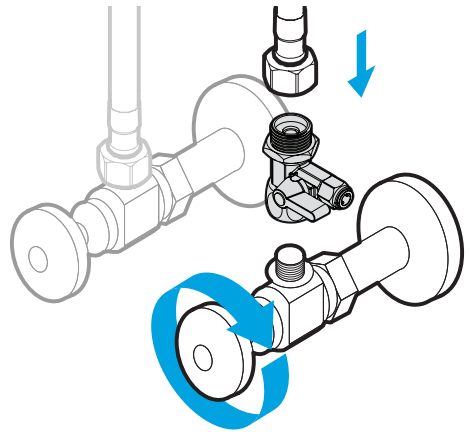

## Install the Faucet

**CAUTION:** Risk of damage. Some kitchen countertop materials, including granite, porcelain, steel, and plastic resin require specialized tools and can be irreparably damaged if unsuitable tools are used.

Installing the faucet requires a 1-inch diameter hole in the countertop or sink. If one does not exist and you are uncomfortable drilling a hole yourself, we strongly suggest hiring a professional to do it for you.

- A.** Insert the small rubber gasket (1) into the base of the faucet. Thread the faucet stem through the hole in the counter, ensuring faucet is fully seated on counter with gasket forming a seal.

**NOTE:** The installation package includes a faucet base (2). If countertop hole is larger than 1", position the base over the countertop hole and thread the faucet stem through that, ensuring faucet is fully seated on base. The small rubber gasket should not be used.

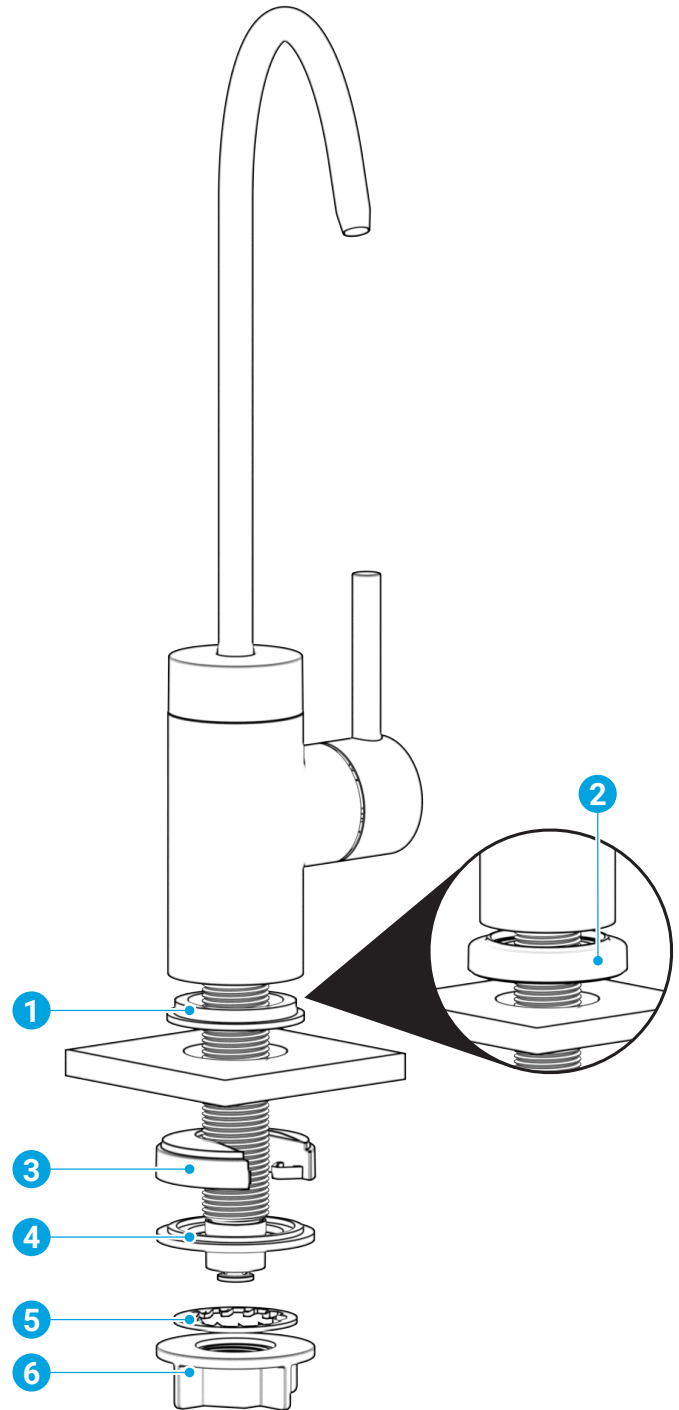

- B.** Under the sink, slide the horseshoe washer (3), smooth side up, up the stem so that it's positioned against the under side of the counter.
- C.** Slide the large rubber washer (4), ridge side up, up the stem, followed by the internal tooth washer (5).
- D.** Secure the fixing components against counter by twisting locking nut (6) up threaded stem. Be sure to check that the faucet is securely fixed to the counter.
- E.** Connect one end of the yellow purified-water PE tube to the quick-connect on the end of the faucet stem. Secure connection with a locking clip.

**NOTE:** Do not connect the other end of the yellow purified-water PE tube to the filtration unit at this time.



## Connect the RO Wastewater Tube

The drain saddle is designed to fit around a standard 1.5 in. OD (outer diameter) drain pipe.

-  Always install the drain saddle before the P-trap and on a straight vertical or horizontal section of the pipe. If installing on the horizontal section, install so that PE tube is located on the top of the pipe.
-  To avoid clogging the drain line with debris, do not install the drain saddle after the drain pipe meets a garbage disposal or dishwasher drain.

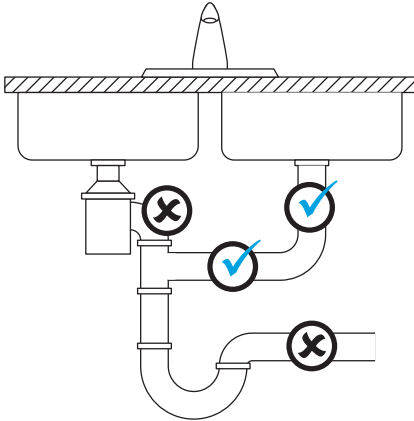

To make the wastewater drain connection:

- A.** Determine location for drain saddle To guide drilling, make a mark on the pipe for opening (1).
- B.** Using adjustable drill with 1/4" drill bit, drill hole at mark. Drill hole in one side of pipe ONLY.
- C.** Remove the backing from the foam gasket. Align the adhesive side of it over the hole on the inside of the drain saddle. Press in place, ensuring a clean opening.
- D.** Position both halves of the drain saddle around the drain pipe, aligning the opening in the drain saddle directly over the drilled hole in the drain pipe. Insert the drill bit through both holes to ensure proper alignment.
- E.** Secure the drain saddle to the drain pipe using the provided nuts and bolts. DO NOT overtighten.
- F.** Insert the long white wastewater PE tube into the quick connect of the drain saddle. Insert to the black line marked on the tube. Insert locking clip under release collar to secure tube.

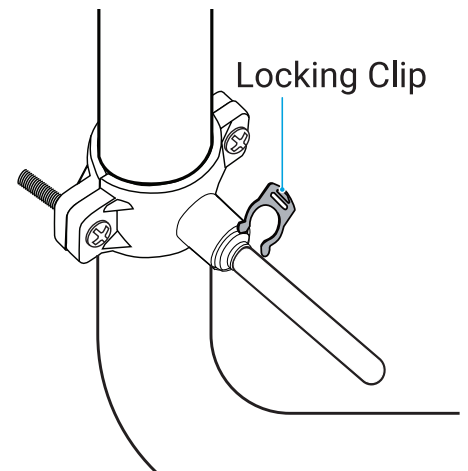
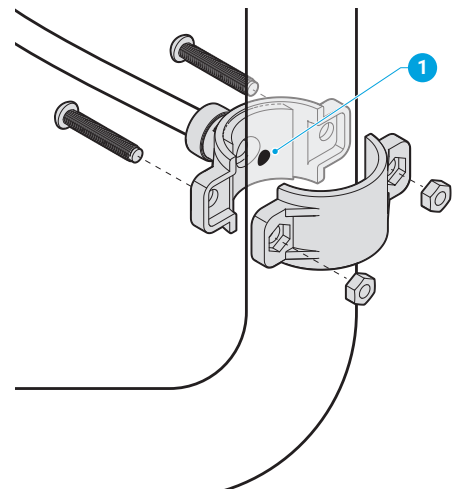

## Connect Tubes to Filtration Unit

**IMPORTANT:** The filtration system has been fitted with protective plugs to ensure system ports are not damaged during shipping. Plugs **MUST BE** removed before connecting tubing. To remove plugs, press down release collar, then pull plug out. **DO NOT** attempt to remove plugs by pulling them out without first releasing them. This may severely damage ports and cause water leakage.

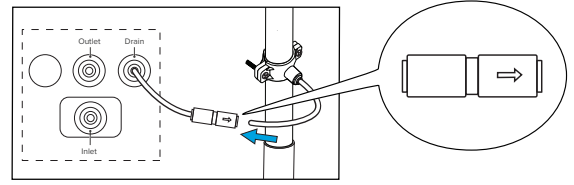

- A. Connect the free end of the long white PE tube connected to the drain saddle to the free end of the preinstalled flow restrictor as show in the illustration.
- B. Connect the free end of the blue inlet-water PE tube connected to the feedwater valve to the raw water inlet (7).
- C. Connect the free end of the yellow purified-water PE tube to the purified water outlet (4).
- D. Secure all PE tubes and fittings by sliding locking clips under release collars.

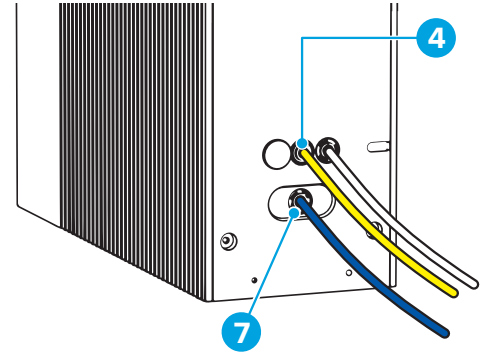

## Check for Leaks

**IMPORTANT:** **DO NOT** connect the filtration unit to the power supply at this time. Always check for leaks before connecting system to power supply.

- A. Ensure all water connections are completed.
- B. Close the faucet.
- C. Open the valve on the feedwater adapter.
- D. Slowly turn on main cold water supply.
- E. Check all connections for any leaks. Immediately turn off main cold water supply if any are detected. Disconnect tubing and reconnect if necessary.
- F. If no leaks are detected, plug in filtration unit. Press power button ON.

## Flush the Filters

Upon initial use of the system and each time a new filter is installed, it needs to be flushed. To do so, follow these steps:

- A. Rotate the handle on the filtration faucet forward to open. Let the water run for 20 minutes.
- B. Close faucet and let system sit for 2 hours.
- C. Open faucet again and let water run for another 20 minutes.
- D. If you have collected any of the dispensed water, discard it.

Filters have now been flushed and you can begin enjoying your new filtration system.

# Operation

The filtration system includes an accessibly designed faucet with a quarter-turn handle. Follow steps below to operate:

- A. To dispense water, rotate handle forward 90 degrees.
- B. To close faucet, rotate handle back to an upright position.

## Indicator Lights and Buttons

The filtration unit has been designed with a simplified touch interface for easy use. The following table describes the function and operation of each light and button.

Indicator Light/Button	Function/Operation
PAC light	When blinking, indicates the PAC filter needs to be replaced.
RO light	When blinking, indicates the RO filter needs to be replaced.
Power light	When illuminated, indicates the filtration system is on and functioning.
Power button	Press to turn filtration unit ON. Press again to turn filtration unit OFF.
PAC button	Press after installing new PAC filter to reset timer.
RO button	Press after installing new RO filter to reset timer.

## Care and Maintenance

Keep the system in a cool, dry place away from direct sunshine.

- Use a clean, soft cloth to remove dust buildup. DO NOT use soap, detergent, or harsh abrasives.
- Never lay the water filtration system on its side or back. It should always be operated and stored in an upright position.
- If the cold water inlet temperature drops to 32°F (0°C), there is a risk the tubes could crack, and damaging leaking could occur. To prevent this, turn off the cold water supply and open filtration faucet to drain any remaining water out of filtration system.
- In the event of a water shutdown or pipeline maintenance, close the feedwater valve, press power button OFF, and unplug filtration unit. Always flush home water lines after any maintenance work has been carried out to keep larger debris from entering the filters.
- If filtration system will not be used for an extended period of time, close the feedwater valve. Before using filtration system again, open the feedwater valve and run water through the filtration faucet for 5 minutes.

## Filter Replacement Schedule

Filter Type	Model No.	Replacement Schedule*	Function
PAC - 400 GPD	RPFTR0M400PAC	Every 12 months or 3,600 liters	Removes dirt, silt, and other suspended solids; also removes chlorine, and unpleasant tastes, odors, and colors.
PAC - 600 GPD 800 GPD	RPFTR0M68PAC	Every 12 months or 3,600 liters	Removes dirt, silt, and other suspended solids; also removes chlorine, and unpleasant tastes, odors, and colors
RO - 400 GPD RO - 600 GPD RO - 800 GPD	RPFTR0M400RO RPFTR0M600RO RPFTR0M800RO	Every 24 months or 7,200 liters	Membrane rated at 0.0001 μ. Removes up to 99% of contaminants, including total dissolved solids, fluoride, and heavy metals like lead and arsenic.

\*Filter life may vary depending on water usage and source water quality.

## Replace the Filters

When one or both of your filter indicators begin to flash, the filter(s) need to be replaced. To change filter:

- A. Close the valve on the feedwater adapter.
- B. Open the filtration faucet and drain water to release pressure.
- C. Press power button OFF. Disconnect power cord from power outlet.
- D. Turn the filter cartridge handle to the left or until filter cartridge releases. Pull cartridge straight out. Dispose of expired filter properly.
- E. Insert the new filter cartridge with the label facing upward.
- F. Push the new cartridge in firmly until it is flush with filtration unit.
- G. Turn filter cartridge handle to the right until filter cartridge clicks into place, and handle is in a vertical position.
- H. Plug filtration unit back in. Press power button ON.
- I. Depending on which filter was replaced, press RO Reset or PAC Reset until filter indicator light stops flashing. Filter timer has now been reset.
- J. Open valve on feedwater adapter and flush new filter(s) according to instructions under "Flush the Filters."

(Fig-16)

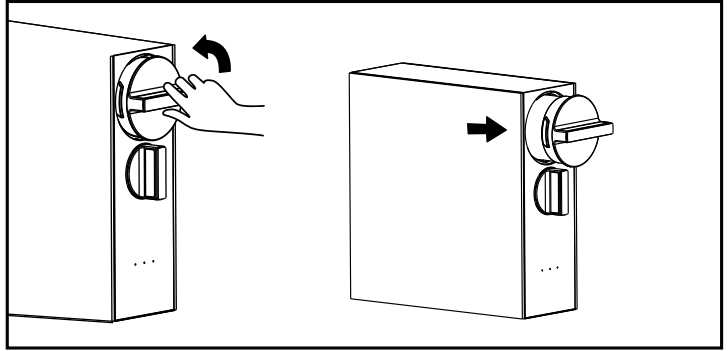

(Fig-17)

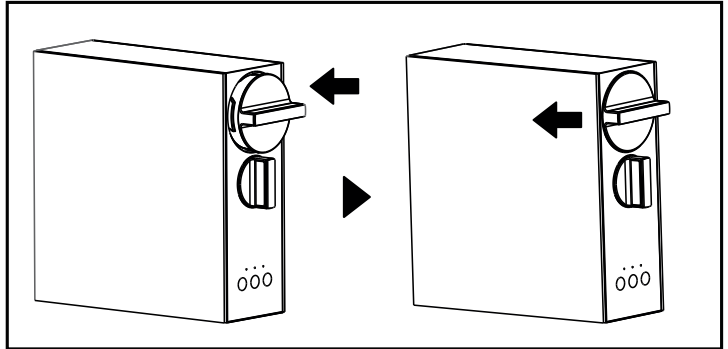

(Fig-18)

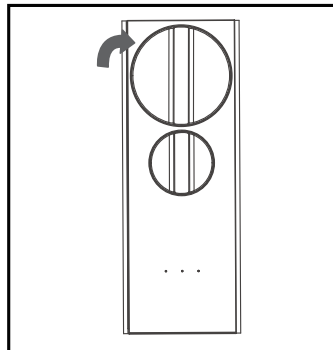

# Troubleshooting

Problem	Probable cause	Solution
The water output volume has dropped.	<ul style="list-style-type: none"> <li>The feedwater valve is not fully open.</li> <li>One or both filters are blocked or have reached the end of their lifespans.</li> </ul>	<ul style="list-style-type: none"> <li>Fully open feedwater valve.</li> <li>Replace one or both filters.</li> </ul>
Change in water taste.	<ul style="list-style-type: none"> <li>One or both filters are defective or have reached the end of their lifespans.</li> <li>The filtration system has not used for 3 or more days.</li> </ul>	<ul style="list-style-type: none"> <li>Replace one or both filters.</li> <li>Open the filtration faucet and flush the system for 5 minutes.</li> </ul>
The filtration unit is leaking.	<ul style="list-style-type: none"> <li>System component failure.</li> <li>Filters not installed correctly.</li> </ul>	<ul style="list-style-type: none"> <li>Close the feedwater valve, power down filtration unit and unplug from power. Contact customer service for assistance.</li> <li>Close the feedwater valve. Remove filters, then reinstall them. Turn feedwater valve on.</li> </ul>
No purified water dispenses from faucet.	<ul style="list-style-type: none"> <li>The water leakage detector has been triggered.</li> <li>An air bubble is blocking the PE tubes (which typically happens after a filter replacement or water supply shutdown).</li> </ul>	<ul style="list-style-type: none"> <li>Close the feedwater valve, power down filtration unit and unplug from power. Inspect lines and pipes for external leaks. Tilt the filtration unit to check for internal leaks. If leakage is internal, water will drain out. Contact customer service for assistance. If the leakage is external, inspect for leaks and fix accordingly. Drain any water from unit by tilting it.</li> <li>Reset leakage detector: Close the feedwater valve, press power button OFF, and unplug unit from power. Disconnect blue inlet tube from the back of the unit, then reconnect blue inlet tube. Open feedwater valve, plug filtration unit back in and press power button ON.</li> <li>Close the feedwater valve, press power button OFF, and unplug unit from power. Open main kitchen faucet and ensure water is flowing. Open feedwater valve, plug filtration unit back in and press power button ON.</li> </ul>

## Modes

Mode	Description
Standby Mode	The filtration unit automatically switches into standby mode after 3 hours of non-use. All indicator lights go off. To exit standby mode, open filtration faucet and dispense water.
Safety Mode	If water is continuously dispensed for 30 minutes, the filtration unit shuts down and water cannot be dispensed. The RO, PAC and Power indicator lights on the filtration unit will flash. To reset, close the faucet and press the power button OFF. Then press the power button ON. The filtration system returns to normal operation.

# Warranty

Brio (“Vendor”) warrants to the original purchaser of the Brio Water Filtration System (the “Product”), and to no other person, that if the Product is assembled and operated in accordance with the printed instructions accompanying it, then for a period of one (1) year from the date of purchase, all parts in the Product shall be free from defects in material and workmanship. This Limited Warranty shall be limited to repair or replacement of parts, which prove defective under normal use and service and which Vendor shall determine in its reasonable discretion upon examination to be defective. To take advantage of this Limited Warranty, please follow these steps:

1. Please retain your sales slip or invoice, as Vendor may require reasonable proof of your date of purchase.
2. Contact Vendor’s Customer Service Department using the contact information listed below.
3. Return parts to Vendor, per Vendor’s instructions, at your cost and expense.
4. Upon receipt by Vendor, Vendor shall advise you in writing whether a defect covered by this Limited Warranty exists in any returned part and whether your claim has been approved or denied.
5. Upon Vendor’s approval of your claim, Vendor will replace such defective part without charge to you.

**WHAT THIS LIMITED WARRANTY DOES NOT COVER:** This Limited Warranty does not cover any failures or operating difficulties of the Product due to accident, abuse, misuse, alteration, misapplication, improper installation or improper maintenance or service by you or any third party, or failure to perform normal and routine maintenance on the Product, as set out in the User’s Manual. In addition, this Limited Warranty does not cover damages to the finish, such as scratches, dents, discoloration or rust after purchase.

This Limited Warranty is the only express warranty given on the Product and is in lieu of all other express warranties. Vendor disclaims all warranties for products that are purchased from seller other than authorized retailers or distributors. THIS LIMITED WARRANTY RESTRICTS THE DURATION OF ANY AND ALL IMPLIED WARRANTIES, INCLUDING WITHOUT LIMITATION, THE IMPLIED WARRANTY OF MERCHANTABILITY AND FITNESS FOR A PARTICULAR PURPOSE TO THE ONE (1) YEAR TERM OF THIS LIMITED WARRANTY. UPON THE EXPIRATION OF THE ONE (1) YEAR TERM OF THIS LIMITED WARRANTY, VENDOR DISCLAIMS ANY AND ALL IMPLIED WARRANTIES, INCLUDING WITHOUT LIMITATION THE IMPLIED WARRANTIES OF MERCHANTABILITY AND FITNESS FOR A PARTICULAR PURPOSE, THE PRODUCT BEING THUS SOLD AS-IS, WITH ALL FAULTS. FURTHER, VENDOR SHALL HAVE NO LIABILITY WHATSOEVER TO PURCHASER OR ANY THIRD PARTY FOR ANY SPECIAL, INDIRECT, PUNITIVE, INCIDENTAL, OR CONSEQUENTIAL DAMAGES. OTHER THAN THIS LIMITED WARRANTY, THERE ARE NO WARRANTIES WHICH EXTEND BEYOND THE DESCRIPTION ON THE FACE HEREOF. Vendor assumes no responsibility for any defects caused by third parties. This Limited Warranty gives you specific legal rights, and you may have other rights which vary from state to state. State law may also override statements in this Limited Warranty regarding the restriction on the duration of implied warranties. Some jurisdictions do not allow exclusion or limitation of special, incidental or consequential damages, or limitations on how long a warranty lasts, so the above exclusion and limitations may not apply to you.





Brio<sup>®</sup>

[WWW.BRIOWATER.COM](http://WWW.BRIOWATER.COM)

©2025 Brio Water Technology, Inc.